

HB&G ROUGHSAWN® BRACE INSTALLATION INSTRUCTIONS

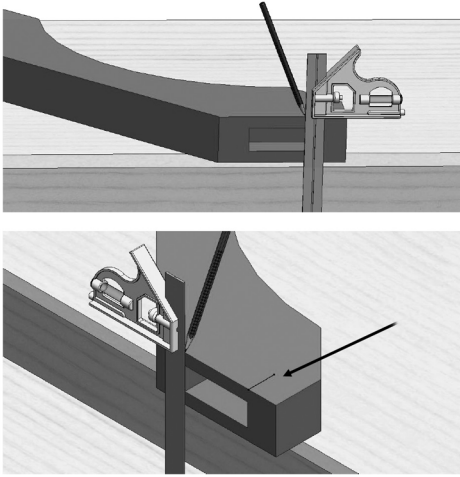

STEP 1: Your brace has 2 rectangular recesses (mortises) on the faces of the brace that attach to the column and beam. Use a carpenter's square to transfer the locations of the short legs of the mortises to one of the side faces of the brace.

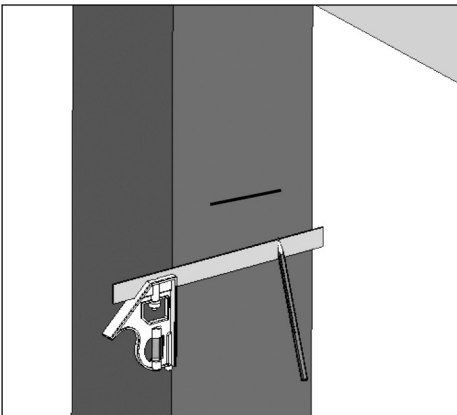
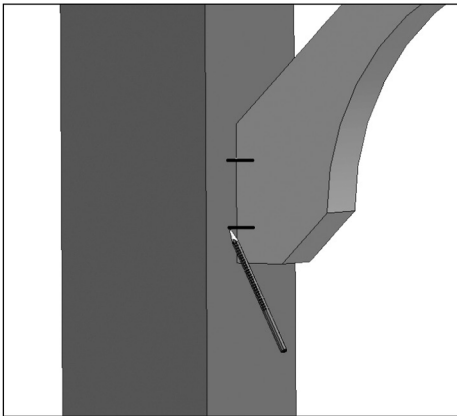

STEP 2: Hold the brace up against the column and beam and transfer the marks you made on the side of the brace onto the face of the column and the underside of the beam. Put the brace aside and use a carpenter's square to extend the marks across the faces of the column and beam.

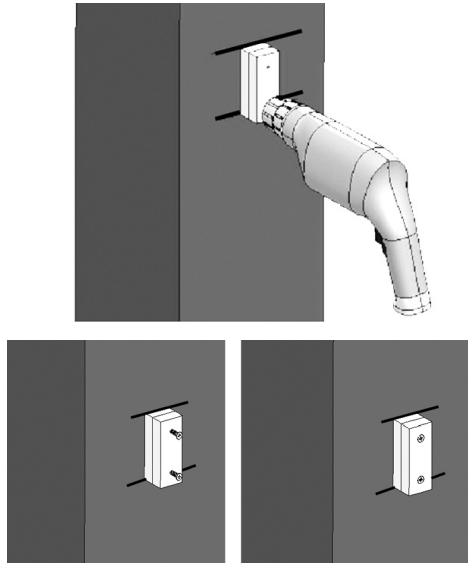

STEP 3: Your brace will have come with 4 white PVC mounting blocks. You will stack two of them together and fasten them to the column shaft and the other two will be stacked together and attached to the underside of the beam. Drill pilot holes through the PVC blocks and into the column shaft. Use 2" or longer decking screws to attach the blocks. Be sure the size of your drill bit is the correct size for the screws you are using. If your screws are #10 size, use a 1/8" diameter drill bit. If your screws are #12 size use a 9/64" diameter drill bit.

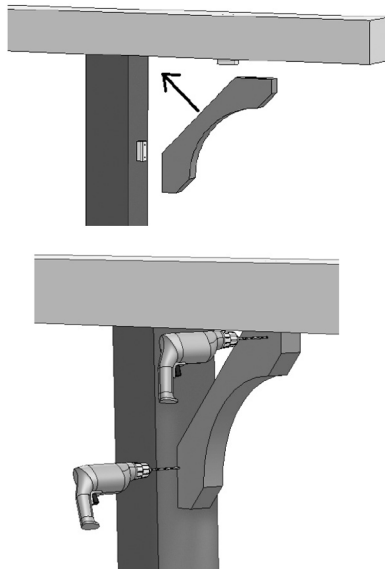

STEP 4: Test fit the brace to make sure it slides over the mounting blocks and that its mounting faces will be tight against the column and beam. Adjust location of mounting blocks, if necessary.

Drill 1/8 pilot holes through the side of the brace into the edge of the concealed mounting blocks on the column and beam.

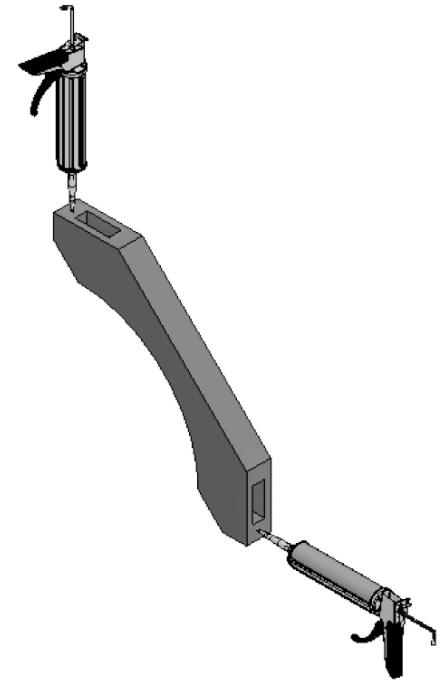

STEP 5: After test fitting the brace, remove it and apply polyurethane construction adhesive to both of the mounting faces of the brace.

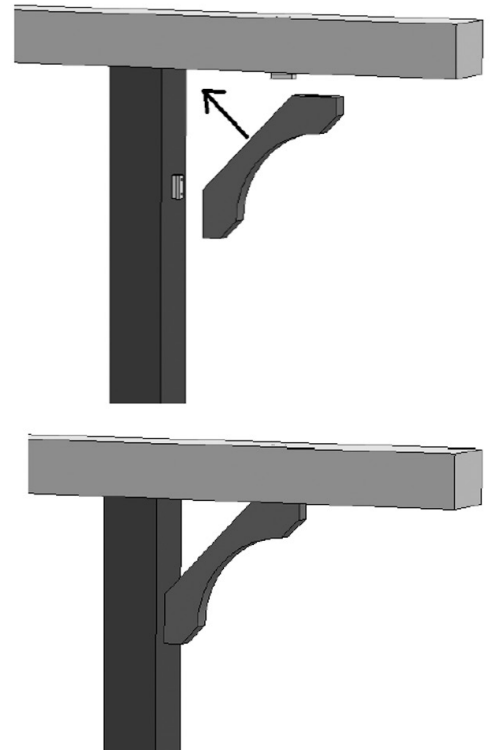

STEP 6: After applying the adhesive, install the brace over the mounting blocks and push it into place. The adhesive will be squeezed between the mounting surfaces of the brace and the mounting surfaces of the column and beam. Clean up any squeeze-out with a clean rag dampened with mineral spirits.

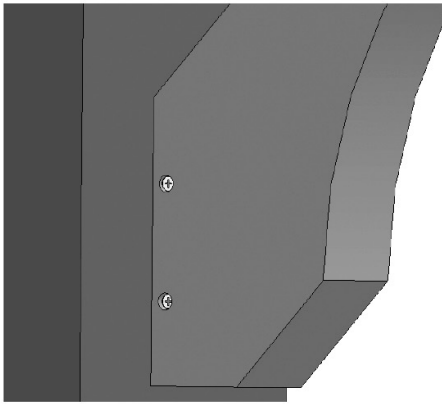
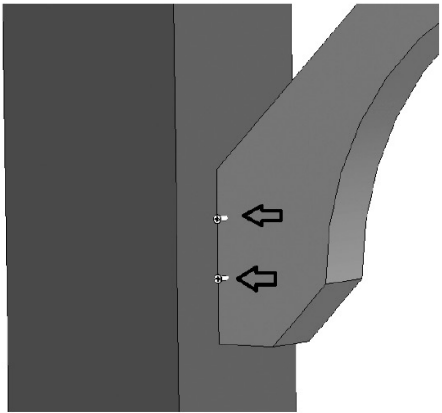

Use 2" or 2-1/2" decking or exterior trim screws and screw through the side of the brace into the edge of the concealed mounting blocks. Make sure the screw heads countersink below the surface of the face of the brace.

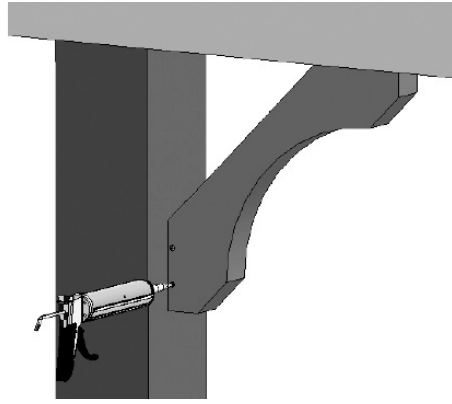

STEP 7: Apply acrylic caulk, painter's putty or lightweight exterior spackle to fill the holes made by the screws.

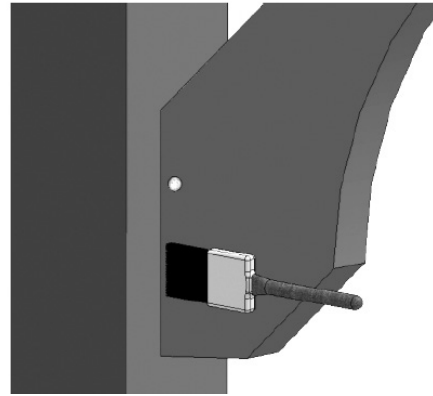

STEP 8: Use a high quality acrylic paint or solid-body opaque acrylic stain to finish the brace.

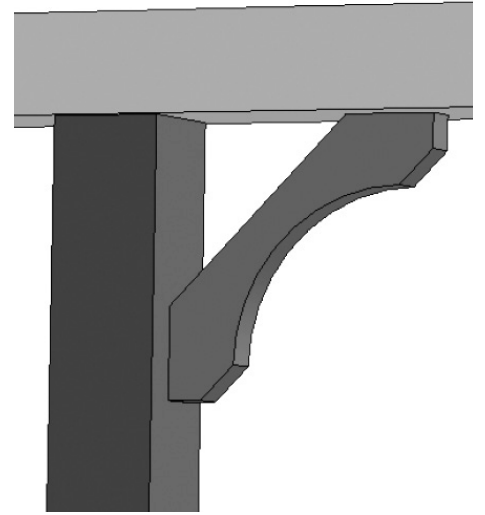

Your installation is complete.

TOOLS NEEDED FOR INSTALLATION		USE
Necessary	Caulking Gun	Apply caulk and construction adhesive
Necessary	Utility Knife	Various
Necessary	Try-square, Combination Square or Framing Square	Mark columns, cap & base trim when cutting to length
Necessary	Rags	Cleanup caulk and adhesive squeeze out
Necessary	Mineral Spirits / Paint Thinner	Cleanup polyurethane adhesive squeeze out
Necessary	Water for Cleanup	Cleanup caulk squeeze out
Necessary	Cordless Drill	Drill holes and drive screws to fasten mounting blocks and to attach brace to mounting blocks
Necessary	Driver Bits - various	Driver bit for screws
Necessary	1/8" Twist Drill Bit	Pilot holes for trim screws securing cap & base trim pieces
SUPPLIES NEEDED FOR INSTALLATION - (to be supplied by installer)		USE
Necessary	#10 or #12 X 2" or 2-1/2" corrosion resistant decking screws	Fasten mounting blocks to column shaft and beam and fasten brace to mounting blocks
Optional	2" or 2-1/2" corrosion resistant trim screws	Alternate fastener to fasten brace to mounting blocks
Necessary	Polyurethane Construction Adhesive	Glue cap and base trim pieces together. Use in combination with trim screws or finish nails
Necessary	Acrylic Caulk or Lightweight Exterior Spackle	Fill countersunk screw holes in side of brace